

ul. Jodłowa 0+214,50

**W1**  
L<sub>1-PT</sub>=286,50  
Y<sub>4</sub> = +0,3°  
L<sub>1-KT</sub>=86,50

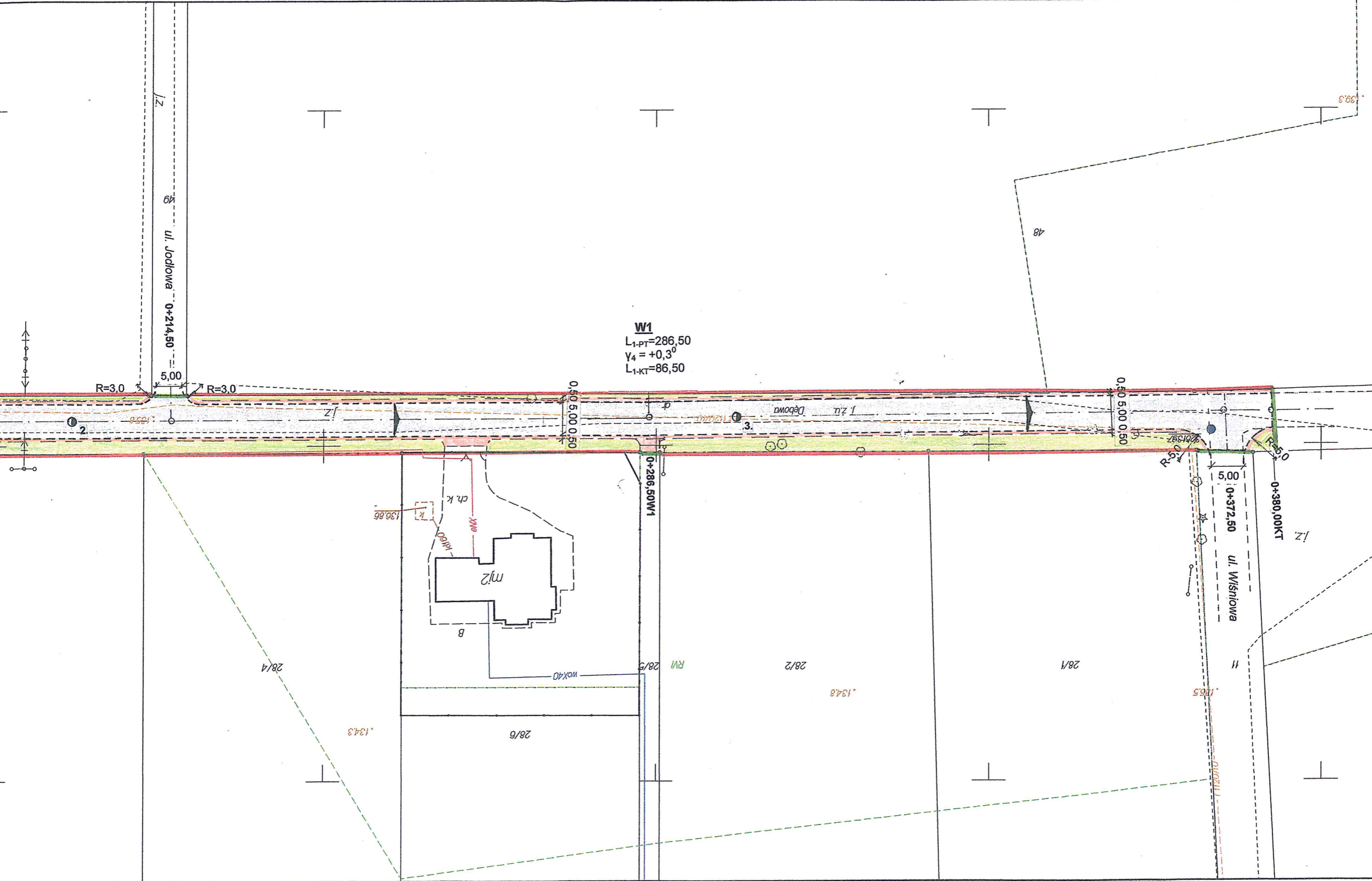

28/4

134,3

28/6

0+286,50W1

RV 28/5

28/2

134,8

28/1

165

ul. Wiśniowa

0+380,00KT

H

48